

Altero 150

Inline mixed flow reversible fans

Use

- Ventilation for bathrooms and kitchens.
- Suitable for limited mounting space.
- Easy mounting.
- Compatible with Ø 150 mm round air ducts.



Air flow:
up to 320 m³/h
89 l/s



Power:
from 34 W



Noise level:
from 34 dBA



Design

- One fan providing supply and exhaust ventilation for different premises.
- The fan casing is equipped with mounting brackets for easy installation.
- Corrosion free.
- Collars with a rubber sealant prevent air leakage and pressure loss.
- The fan is equipped with a service door and removable ventilator block for easy maintenance.
- Built-in automatic control board.
- Built-in revision door for convenient maintenance.
- Vibration free operation.

Motor

- Specifically designed impellers provide a powerful, yet smooth and quiet air flow.
- Motor with thermal overload protection.
- Long-life ball bearing (up to 40 000 hours).
- Three-year warranty from time of installation.

Speed control

- Integrated controller provides automatic switching between supply and exhaust modes in accordance with code requirements.

Application example

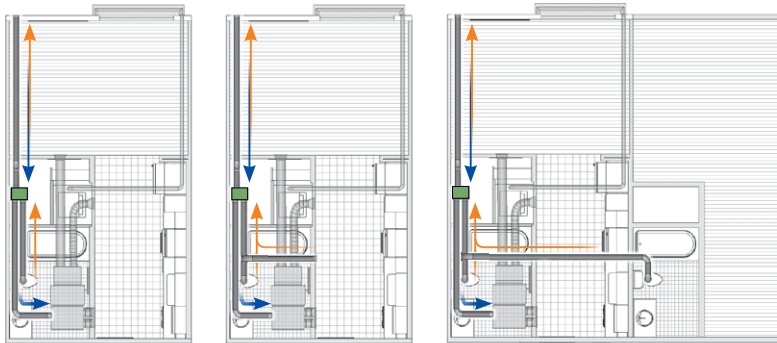

1 BATHROOM

1 BATHROOM + KITCHEN

2 BATHROOMS

Accessories

Air disc valves



VPR / VSR / VMR

Duct system



BlauPlast

Flexible air ducts



BlauFlex

Grilles and hoods



Decor / GM

Clamps



K / KZ

Mounting

- The combination of supply and exhaust, along with a low profile housing, makes this fan suitable for low ceilings and tight spaces.
- One duct replacing the bathrooms, kitchen (when applicable) and outside air ducts.
- The amount of drop ceilings will be reduced due to eliminating ducts.
- Eliminates clearance requirements between outside air and bathrooms/ kitchen (low rise).
- Easy installation.

Designation key

Series	Duct diameter [mm]
Altero	150

Overall dimensions [mm]

Type	∅ D	∅ D1	H	B	B1	L	L1	L2
Altero 150	12	149	212	532	381	329	428	265

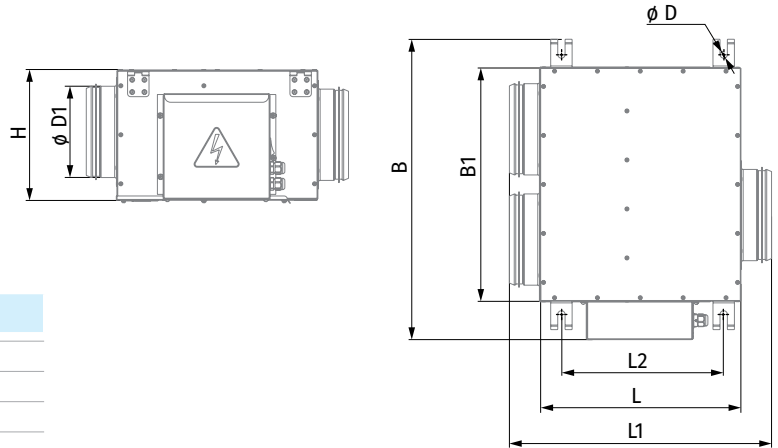

Technical data

Parameters	Altero 150
Voltage [V]	1 ~ 230
Frequency [Hz]	50/60
Power [W]	34
Current [A]	0.15
Maximum air flow [m³/h (l/s)]	320 (89)
RPM [min⁻¹]	2300
Sound pressure at 3 m [dBA]	34
Transported air temperature [°C]	60
IP rating	IPX4
SEC class	B
ErP	2018

ALTERO 150

Sound power level, A-weighted	Total	Octave frequency bands [Hz]								LpA 3 m	LpA 1 m
		63	125	250	500	1000	2000	4000	8000		
LWA to inlet [dBA]	60	20	31	57	51	51	50	39	27	39	49
LWA to outlet [dBA]	59	20	31	56	51	51	49	39	26	39	48
LWA to environment [dBA]	54	16	27	51	46	47	45	36	24	34	44

