



SMART Wi-Fi

Ø100/125

Axial intelligent fan
USER'S MANUAL



CONTENTS

Delivery set.....	6
Technical data.....	6
Installation and set-up.....	9
Connection to power mains	11
Operation guidelines	11
Unit control	12
Storage and transportation regulations.....	24
Technical maintenance.....	25
Manufacturer's warranty	26

This user's manual is a main operating document intended for technical, maintenance, and operating staff.

The manual contains information about purpose, technical details, operating principle, design, and installation of the Smart Wi-Fi unit and all its modifications.

Technical and maintenance staff must have theoretical and practical training in the field of ventilation systems and should be able to work in accordance with workplace safety rules as well as construction norms and standards applicable in the territory of the country.

The information in this user's manual is correct at the time of the document's preparation.

The Company reserves the right to modify the technical characteristics, design, or configuration of its products at any time in order to incorporate the latest technological developments.

No part of this publication may be reproduced, stored in a retrieval system, or transmitted, in any form or by any means in any information search system or translated into any language in any form without the prior written permission of the Company.

READ THE USER'S MANUAL CAREFULLY BEFORE PROCEEDING WITH INSTALLATION WORKS.



COMPLIANCE WITH THE MANUAL REQUIREMENTS ENSURES RELIABLE OPERATION AND LONG SERVICE LIFE OF THE UNIT.

KEEP THE USER'S MANUAL AVAILABLE AS LONG AS YOU USE THE UNIT. YOU MAY NEED TO RE-READ THE INFORMATION ON THE PRODUCT SERVICING.



FOLLOW THE USER'S MANUAL REQUIREMENTS TO ENSURE DURABLE AND TROUBLE-FREE OPERATION OF THE UNIT.

Disconnect the unit from power supply prior to any connection, servicing, maintenance, and repair operations.

Only qualified electricians with a work permit for electrical units up to 1000 V are allowed for installation and maintenance. The present user's manual should be carefully read before beginning works.

- Single-phase power mains must comply with the acting local electrical norms and standards.
- Fixed electrical wiring must be equipped with an automatic circuit breaker.
- The unit must be connected to power mains through a QF automatic circuit breaker integrated into the fixed wiring system. The gap between the circuit breaker contacts on all poles must be not less than 3 mm. Check the unit for any visible damages of the impeller and the casing before starting installation. The casing internals must be free of any foreign objects that can damage the impeller blades.
- While mounting the unit, avoid compression of the casing! Deformation of the casing may result in the motor jam and noisy operation. Misuse of the unit and any unauthorised modifications are not allowed.
- Take steps to prevent ingress of smoke, carbon monoxide, and other combustion products into the room through open chimney flues or other fire-protection devices. Sufficient air supply must be provided for proper combustion and exhaust of gases through the chimney of fuel burning equipment to prevent back drafting. Transported air must not contain any dust or other solid impurities, sticky substances, or fibrous materials.
- Do not use the unit in a hazardous or explosive environment containing spirits, gasoline, insecticides, etc.
- Do not close or block the intake or extract vents in order to ensure the efficient air flow.
- Do not sit on the unit and do not put objects on it.

- The unit is allowed to be used by children aged from 8 years old and above and persons with reduced physical, sensory, or mental capabilities or no experience and knowledge provided that they have been given supervision or instruction regarding safe use of the unit and understand the risks involved.
- Do not allow children to play with the unit.



**THE PRODUCT MUST BE DISPOSED SEPARATELY AT THE END OF ITS SERVICE LIFE.
DO NOT DISPOSE THE UNIT AS UNSORTED MUNICIPAL WASTE.**

DELIVERY SET

Fan	1 pc.
Logo	1 pc.
Spigot Ø 100 mm	1 pc.
Spigot Ø 125 mm	1 pc.
Screws and dowels	4 pcs.
User's manual	1 pc.
Packing box	1 pc.

TECHNICAL DATA

The product described herein is the axial fan made of high-quality plastic designed for extract ventilation within small and medium-sized residential premises that are heated during the winter period.

The unit design is constantly being improved, thus some models may be slightly different from those described in this manual.

Voltage [V]	100-240
Frequency [Hz]	50-60
Maximum power [W]	6.0
Current [A]	0.07
RPM [min ⁻¹]	2200
Maximum air capacity [m ³ /h]	133
Electrical protection class	IP44

TECHNICAL DATA

Model	Spigot diameter	Speed	Maximum power, [W]	Current, [A]	RPM, [min ⁻¹]	Air flow, [m ³ /h]	Noise level at, 3 m [dBA]
Smart Wi-Fi	100	24 hours	1.6	0.02	950	33	17
		Silent	2.9	0.04	1650	72	21
		Max	5.6	0.06	2150	106	31
	125	24 hours	1.7	0.03	850	40	17
		Silent	3	0.04	1350	83	22
		Max	6	0.07	2200	133	32

FAN MODIFICATIONS

Model	Functions							
	Humidity control	24 hours	Turn-on delay timer	Turn-off delay timer	Speed control	Interval ventilation	External switch	Motion sensor
Smart Wi-Fi	+	+	+	+	+	+	+	
Smart Wi-Fi IR	+	+	+	+	+	+	+	+

OVERALL DIMENSIONS

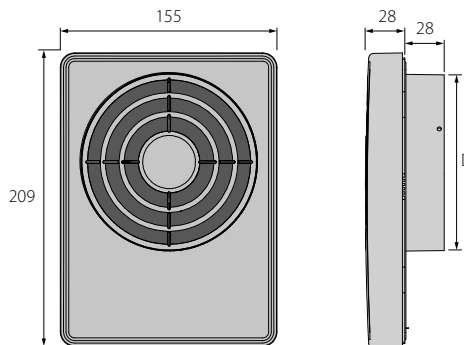

FAN OPERATION MODES

Standby mode – the fan motor does not rotate, the rotation is activated when the **24 hours** mode is activated by a mobile application or by a signal from a temperature/humidity/motion or an external switch.

24 hours - fan operation at low speed to ensure minimum round-the-clock ventilation.

When a temperature/humidity/motion or an external switch is triggered, the fan switches to **Silent** or **Max** mode.

Silent – silent operation mode of the fan. This mode is activated by a motion sensor or an external switch.

Max – high-speed fan operation mode, which is activated when a humidity or temperature sensor is triggered or Boost Mode is activated via the mobile application.

INSTALLATION AND SET-UP

1. In case of vertical mounting the fan must be protected against water and condensation collecting inside the fan.

Fan installation with direct air discharge upwards is not allowed.

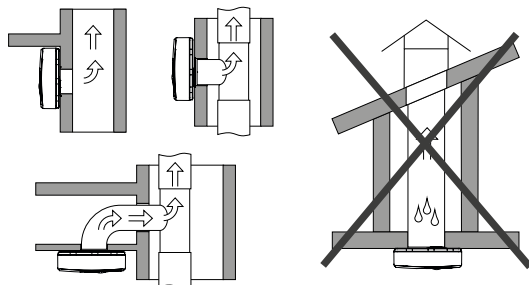

3. Remove the front panel of the fan.

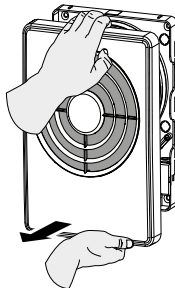

2. Before starting the installation, make sure all electricity has been turned off!

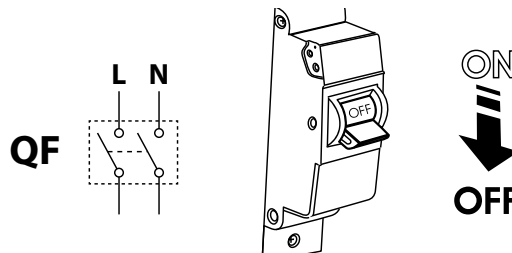

4. Mark the holes for fixing the fan and the power cable.

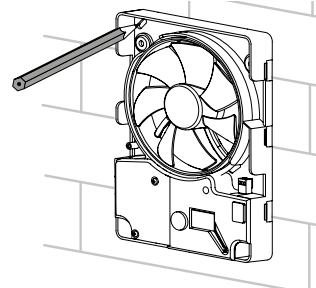

5. Lead the power cable to the ventilation hole, drill the mounting holes and install the dowels.

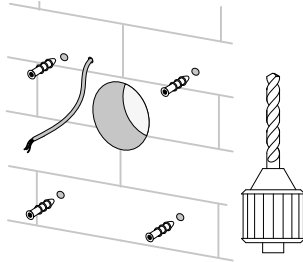

6. Fix the fan with the screws.

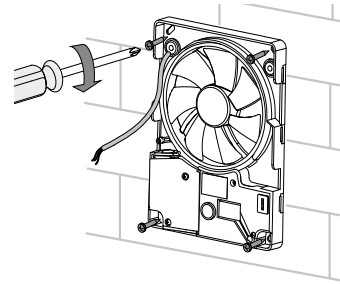

7. Remove the cover to access the terminal block and connect the fan to power mains according to the wiring diagram. Assemble the fan in the reverse order.

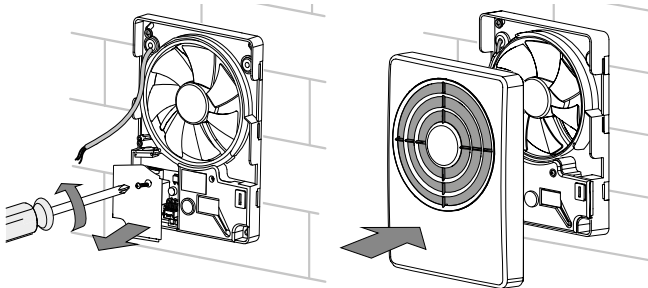

8. Supply power to the fan.

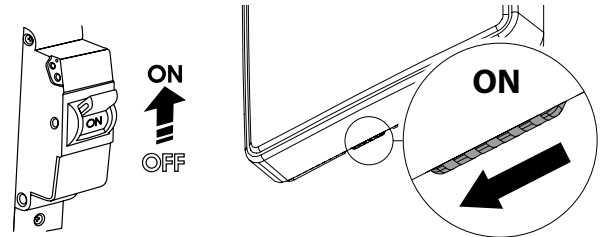

CONNECTION TO POWER MAINS

The fan is rated for connection to single-phase AC 100-240 V/50 (60) Hz.

TERMINAL DESIGNATIONS ON WIRING DIAGRAM:

L – phase

N – 0

LT – fan speed control circuit

LI – output for external load connection

SK – switch for speed change

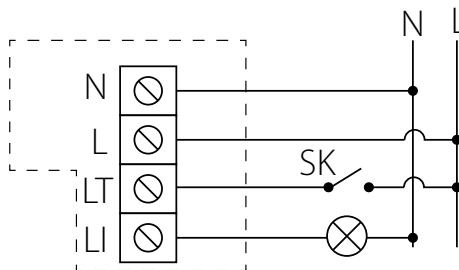

OPERATION GUIDELINES

Ingress protection rating against access to hazardous parts and water ingress is IP44.

The fan is rated for operation at the ambient temperature ranging from +1 °C up to +45 °C.

The unit is rated as a Class II electrical appliance.

UNIT CONTROL

The fan is controlled by the application on the mobile device.

The application is available for download at [App Store](#), [Play Market](#) or via the QR code.



App Store download link

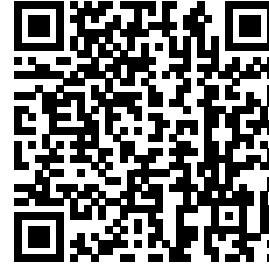

Play Market download link

By default, the fan operates as a Wi-Fi access point.

After installing the application, connect the mobile device to the fan as to a Wi-Fi access point (FAN: + 16 characters of the ID number) indicated on the control board and on the fan casing.

Wi-Fi hotspot password: 11111111.

Run the installed application on the mobile device connected to the fan. When starting the application, a message on the absence of communication with the fan appears on the screen if the device is not connected to the fan.

Warning!

No communication with device!
Check the Wi-Fi connection.

Select a desired connection type.

1. Enter the app menu.
2. Select **Connection-Connection list**.
3. If the fan is operating in Wi-Fi access point mode, select the **Default** connection. Connection is initiated automatically.
4. If the fan is connected to a home Wi-Fi network, search for devices on the network.
5. In the list, you will see a connection with the ID number of the fan. Highlight it.
6. If necessary, change the connection name.
7. Save the updated details.

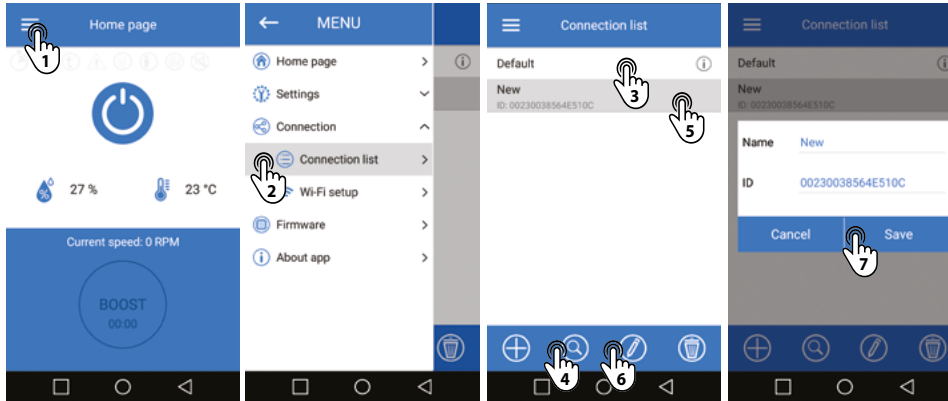

WI-FI PARAMETER SETUP

Go to the application menu on your mobile device **Menu–Connection–Wi-Fi setup**.

Then, press **Receive**. The screen will display the current Wi-Fi parameter settings.

Select one of the Wi-Fi operation modes: **Access point or Client**.

Access point – access point mode without a home router.

In this mode, up to 8 mobile devices can be connected to the fan to control it.

Select the desired security level for the **Access point** mode:

- **Open** – open Wi-Fi network without a password.
- **WPA PSK** – password-protected. Encryption technology, using the **WPA** protocol, which does not guarantee complete security.
- **WPA2 PSK** – type of data encryption for modern network devices.
- **WPA/WPA2 PSK** – password-protected (recommended). Combined technology that activates **WPA** and **WPA2** and at the same time provides maximum compatibility with any of your devices.

Enter your access point password and press the **APPLY** button.

Client – the fan operates on the home router network.

Enter the home router details for the **Client** mode.

- Enter the name of the Wi-Fi home router access point.
 - Enter the password for the Wi-Fi home router access point.
- Then press the **APPLY** button.

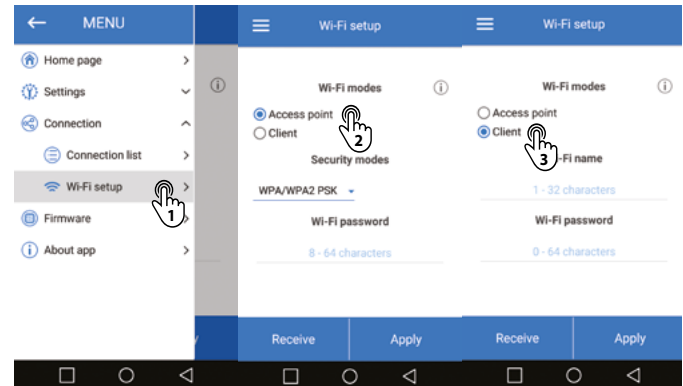

SPECIAL «SETUP MODE/RESET»

To restore the Wi-Fi password or connect to the fan in order to change the settings, **Setup Mode** is provided .

To enter the **Setup Mode**, press and hold the button below the front panel of the ventilator for 5 seconds until the LED starts blinking blue.

The unit will continue in this mode for 3 minutes and then will automatically revert to the previous settings.

To immediately exit the setup mode, press and hold the button again for 4 seconds until the LED stops blinking blue and starts glowing red. In **Setup Mode**, connect to the fan using a mobile device:

Wi-Fi name: Setup mode.

Wi-Fi password: 11111111.

To reset factory settings, press and hold the button for 14 seconds until the LED starts blinking red and a beep is produced.

ACCESS TO THE BUTTON

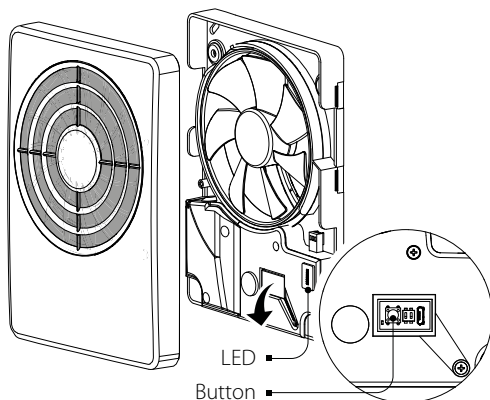

The LED has the following states:

- **Switched off.** Normal operation mode of the device.
- **Glowing blue.** Warning of switching the device to the **Setup Mode**.
- **Blinking blue.** The device is in Setup Mode.
- **Glowing red.** Warning of return to factory settings or exit from the **Setup Mode**.
- **Blinking red.** All the fan parameters are successfully reset to factory settings.

HOME PAGE

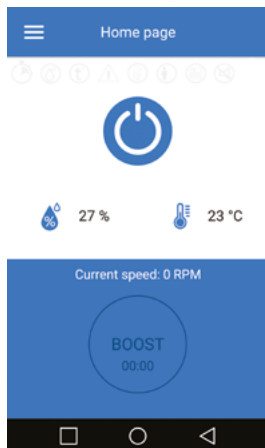









turning the fan on/off





switching the **BOOST** mode on/off.

The timer is set in the menu **Settings – Timers** (Turn-off delay timer). The speed is set in the menu **Settings – Modes** (Max speed).

Indicators:

-  — turn-on or turn-off delay timer operation indicator
-  — humidity exceeding indicator
-  — temperature rise indicator
-  — warning indicator (battery needs replacing)
-  — external switch operation indicator
-  — motion sensor indicator
-  — **Interval ventilation** mode indicator
-  — **Do Not Disturb** mode indicator

Sensor readings:

-  — current temperature
-  — current humidity

CLOCK WITH CURRENT TIME

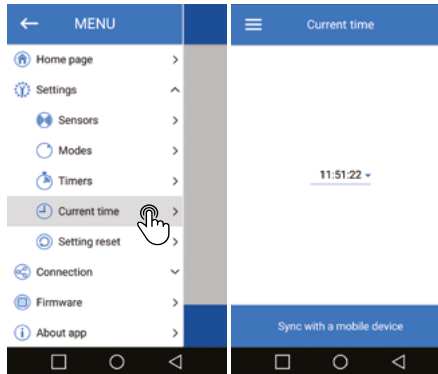

To set the clock for the current time, go to the **Settings-Current time menu**.

Current time is used to indicate the time and operation of some scheduled modes (see **Modes**).

When the fan is disconnected from the mains, the clock continues to operate from an external power source.

FACTORY SETTINGS RESTORE

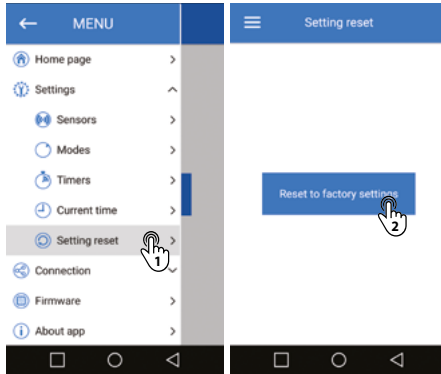

To restore the factory settings, go to the **Settings–Setting reset** menu. Then click **Reset to factory settings**.

After restore, connection with device may be lost due to Wi-Fi settings reset. If necessary, reset your Wi-Fi connection.

You can also reset the settings using the **Setup Mode/Reset** button.

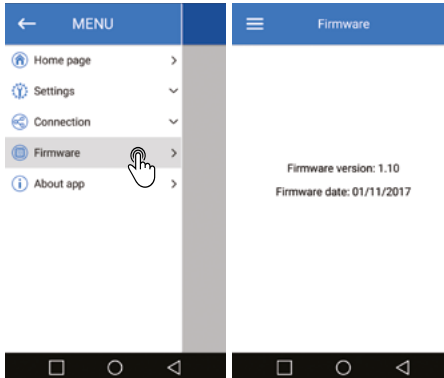

FIRMWARE

To view the firmware version, go to the **Menu–Firmware**. This menu displays the current firmware version and date.

SENSOR OPERATION SETUP

When setting up the sensors, take into account that it is possible to select the operation by a temperature sensor or any other sensors (humidity, motion an external switch).

ADJUSTMENT OF OPERATION BASED ON TEMPERATURE SENSOR

Go to the **Settings–Sensors** menu, set and activate the temperature sensor. Thereafter, adjustment of other sensors is not possible. Then set the temperature threshold.

If the temperature threshold is exceeded longer than the turn-on delay timer, the fan will switch to the **MAX** high speed to remove excess heat.

After the room temperature drops 4 °C below the set threshold, the fan switches to the previous mode.

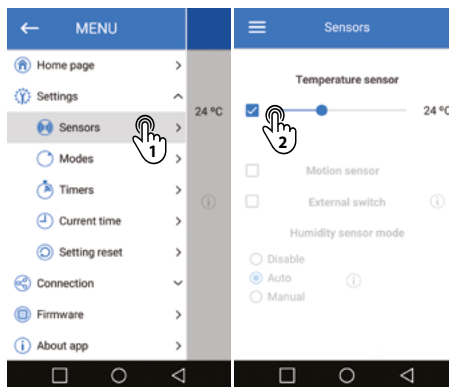

ADJUSTMENT OF OPERATION BASED ON HUMIDITY SENSOR

Go to the **Settings–Sensors** menu and deactivate the temperature sensor, then select one of the humidity sensor operating modes. Three modes are available:

Disable – the humidity sensor is deactivated.

Auto – intelligent humidity control.

This mode provides for changing the humidity threshold and fan speed selection in automatic mode, independently choosing the optimal threshold for the room where the fan is located.

The choice of the fan operation algorithm is determined by analysing the indoor humidity level statistics.

Manual – manual mode, which allows you to set the threshold in the range of 40 % to 80 %.

If the threshold is exceeded for more than the set turn-on delay timer, the fan switches to the **Max** high speed.

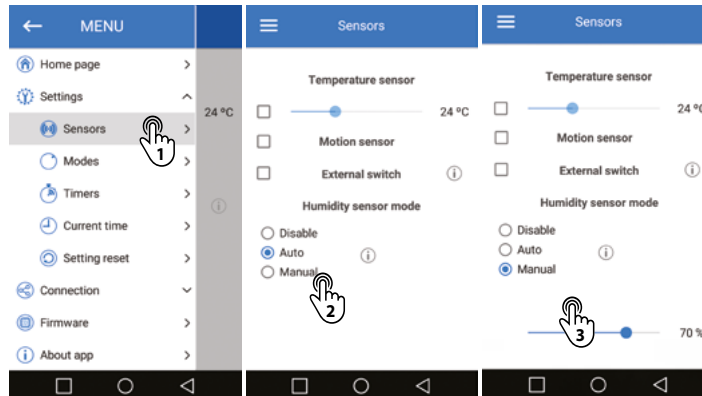

ADJUSTMENT OF OPERATION BASED ON MOTION SENSOR

Go to the **Settings–Sensors** menu and activate the motion sensor.

If this sensor selection is inactive, then deactivate the temperature sensor first.

When the motion sensor is triggered, the turn-on delay timer is switched on, and the fan switches to the **Silent** speed.

When the sensor detects no more motion, the fan goes to standby mode after the turn-off delay timer expires.

ADJUSTMENT OF OPERATION BASED ON EXTERNAL SWITCH

Go to the **Settings–Sensors** menu and activate the external switch.

If this sensor selection is inactive, then deactivate the temperature sensor first.

When the external switch terminals are closed, the fan switches to the **Silent** speed.

When the external switch terminals are opened after the turn-off delay timer expires, the fan goes to standby mode.

When the external switch is closed, the power switching occurs on the external load terminal, which allows, for example, room lighting connection.

The load is commutated by the switch, regardless of the fan turn-on/off delay timers or of the motion sensor.

OPERATION MODES

To configure the operating modes, go to the **Settings–Modes** menu.

24 hours – when this mode is activated, the fan is on and operates at minimum speed. When sensors are triggered, the fan will go to a higher speed.

Silent – fan speed for **Silent** mode. The speed is set from 30 % to 100 % of the total fan capacity.

Max – fan speed for **Max** mode.

The speed is set from 30 % to 100 % of the total fan capacity.

Do not disturb – the function is only available when the **24 hours** mode is activated. This function allows for setting the time interval so that the fan will not respond to sensors or switch triggering, and will operate at minimum speed.

Interval ventilation – the function is only available when the **24 hours** mode is deactivated.

The function allows ventilation in the room every 12 hours for 30 minutes at the set speed, if during the previous day the fan wasn't turned on to one of the sensors.

The interval ventilation speed is adjusted by the slider after the function is activated.

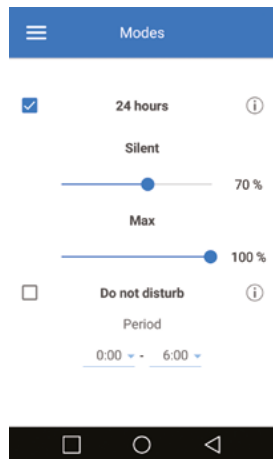

TIMER SETUP

To configure the timers, go to the **Settings-Timers** menu.

Turn-off delay timer is designed to prolong the fan operation in the mode caused by sensor triggering or **Boost Mode** activation, after sensor threshold values are not exceeded any more.

The operating time of the timer may be terminated:

- When the timer expires.
- When the sensor that caused the delay is disconnected (if other sensors are not activated and do not exceed the threshold).
- When the **Boost** button is manually turned off from the application (only when **Boost Mode** is activated).
- When the fan is deactivated from the application or the switch on the fan casing.

Turn-on delay timer is designed to delay the transition to increased speed when the sensors are triggered.

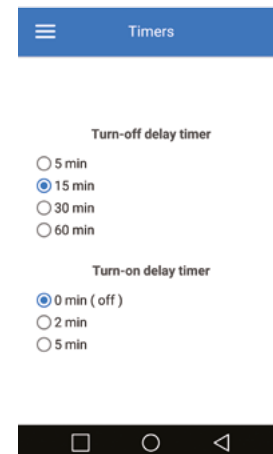

BATTERY REPLACEMENT

If the battery is low or dead, the corresponding warning indicator appears on the home page in the application (see page 16).

If such an indicator appears on the home page, replace the battery.

To do this, power off the fan, remove the front panel and the cover protecting the control circuit board.

Replace the battery (battery type – CR1220) located on the control board.

Reassemble the fan in reverse order, then apply power to the fan.

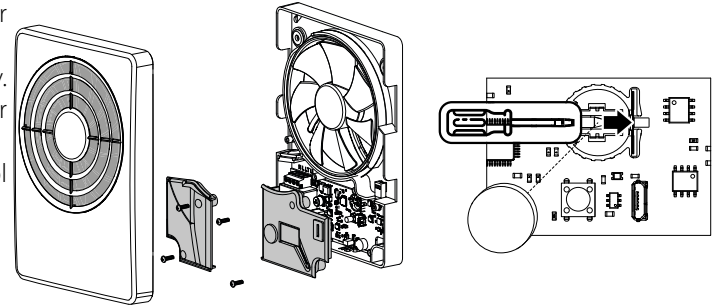

STORAGE AND TRANSPORTATION REGULATIONS

- Store the unit in the manufacturer's original packaging box in a dry closed ventilated premise with temperature range from +5 °C to + 40 °C and relative humidity up to 70 %.
- Storage environment must not contain aggressive vapours and chemical mixtures provoking corrosion, insulation, and sealing deformation.
- Use suitable hoist machinery for handling and storage operations to prevent possible damage to the unit.
- Follow the handling requirements applicable for the particular type of cargo.
- The unit can be carried in the original packaging by any mode of transport provided proper protection against precipitation and mechanical damage. The unit must be transported only in the working position.
- Avoid sharp blows, scratches, or rough handling during loading and unloading.
- Prior to the initial power-up after transportation at low temperatures allow the unit to warm up at room temperature for at least 3-4 hours.

TECHNICAL MAINTENANCE

1. Turn the lock button on the fan to the lock position.
Fan operation will be locked.

WARNING! The locking does not remove the voltage from the fan power terminals!

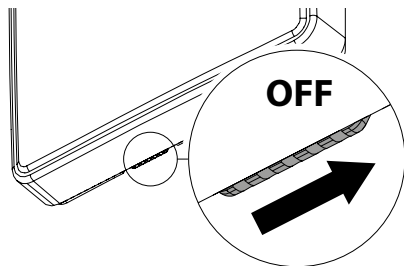

3. Wash the front panel under running water.
Wipe the front panel surface dry.

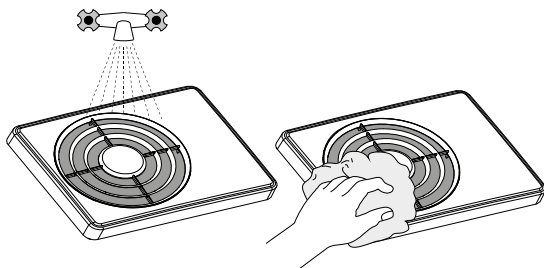

2. Remove the front panel.
Clean the fan blades with a soft dry cloth or brush.

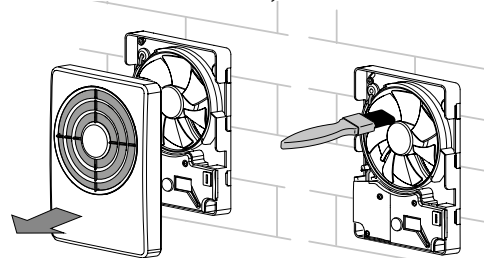

4. Set the lock button to the working position.
Then activate the fan from the mobile application.

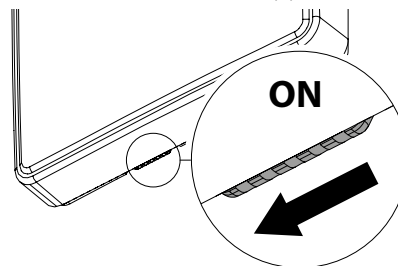

MANUFACTURER'S WARRANTY

The product is in compliance with EU norms and standards on low voltage guidelines and electromagnetic compatibility. We hereby declare that the product complies with the provisions of Electromagnetic Council Directive 2014/30/EU, Low Voltage Directive 2014/35/EU and CE-marking Directive 93/68/EEC. This certificate is issued following test carried out on samples of the product referred to above. The manufacturer hereby warrants normal operation of the unit for 60 months after the retail sale date provided the user's observance of the transportation, storage, installation, and operation regulations. Should any malfunctions occur in the course of the unit operation through the Manufacturer's fault during the guaranteed period of operation, the user is entitled to get all the faults eliminated by the manufacturer by means of warranty repair at the factory free of charge. The warranty repair includes work specific to elimination of faults in the unit operation to ensure its intended use by the user within the guaranteed period of operation. The faults are eliminated by means of replacement or repair of the unit components or a specific part of such unit component.

The warranty repair does not include:

- routine technical maintenance
- unit installation/dismantling
- unit setup

To benefit from warranty repair, the user must provide the unit, the user's manual with the purchase date stamp, and the payment paperwork certifying the purchase. The unit model must comply with the one stated in the user's manual. Contact the Seller for warranty service.

The manufacturer's warranty does not apply to the following cases:

- User's failure to submit the unit with the entire delivery package as stated in the user's manual including submission with missing component parts previously dismantled by the user.
- Mismatch of the unit model and the brand name with the information stated on the unit packaging and in the user's manual.
- User's failure to ensure timely technical maintenance of the unit.

- External damage to the unit casing (excluding external modifications as required for installation) and internal components caused by the user.
- Redesign or engineering changes to the unit.
- Replacement and use of any assemblies, parts and components not approved by the manufacturer.
- Unit misuse.
- Violation of the unit installation regulations by the user.
- Violation of the unit control regulations by the user.
- Unit connection to power mains with a voltage different from the one stated in the user's manual.
- Unit breakdown due to voltage surges in power mains.
- Discretionary repair of the unit by the user.
- Unit repair by any persons without the manufacturer's authorization.
- Expiration of the unit warranty period.
- Violation of the unit transportation regulations by the user.
- Violation of the unit storage regulations by the user.
- Wrongful actions against the unit committed by third parties.
- Unit breakdown due to circumstances of insuperable force (fire, flood, earthquake, war, hostilities of any kind, blockades).
- Missing seals if provided by the user's manual.
- Failure to submit the user's manual with the unit purchase date stamp.
- Missing payment paperwork certifying the unit purchase.



FOLLOWING THE REGULATIONS STIPULATED HEREIN WILL ENSURE A LONG AND TROUBLE-FREE OPERATION OF THE UNIT.



USER'S WARRANTY CLAIMS SHALL BE SUBJECT TO REVIEW ONLY UPON PRESENTATION OF THE UNIT, THE PAYMENT DOCUMENT AND THE USER'S MANUAL WITH THE PURCHASE DATE STAMP.

Quality Inspector's Stamp

Sold by
(name and stamp of the seller)

Manufacture Date

Purchase Date

