

TRIO ONE

SILENT & ENERGY SAVING

Low noise and low power exhaust axial fan with air flow up to 95 m³/h suitable for use in Zone 1



Air flow:
up to 95 m³/h
26 l/s



Power:
from 8 W

SFP:
from 0.3 W/l/s



Noise level:
from 27 dBA



Features



- Wall and ceiling mounting.
- The casing, impeller and the front panel are made of high-quality and UV-resistant ABS plastic.
- Advanced 7-blade impeller aerodynamic profile provides even better performance and lower noise level.
- The fan outlet pipe incorporates specially designed air rectifiers to reduce air turbulence, noise level and increase air pressure.
- The fan is equipped with a specially designed backdraft damper to prevent back flow and heat losses during the fan standby.
- Ventilation shaft mounting or connection to Ø 100 mm air ducts.
- Maintenance-free bearings contain enough grease for 40 000 hrs of non-stop operation.

Options



Model	Trio One 100			
	S	T	TR	H
Pull cord switch	•			
Turn-on delay timer			•	
Turn-off delay timer		•	•	•
Humidity sensor				•

- **Turn-on delay timer**
 - Adjustable delay from 10 seconds to 2 minutes.
- **Turn-off delay timer**
 - Adjustable delay from 2 to 30 minutes.
- **Humidity sensor**
 - Humidity sensor activation threshold is adjustable from 60 % to 90 %.

Overall dimensions and mounting

- The fan is installed directly into the ventilation shaft.
- Flexible duct connection is recommended in case of the remote ventilation shaft location. The air duct is connected to the fan exhaust spigot through a clamp.
- Fixation to the wall or ceiling with screws.

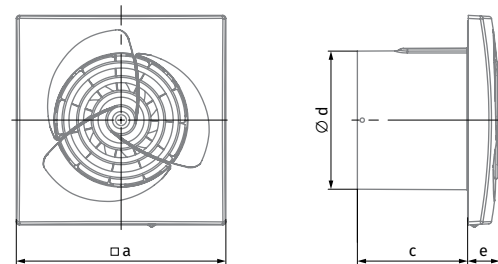

Dimensions [mm]	a	c	Ø d	e
Trio One 100	150	79	99	23

Designation key		
Trio One	100	H
Model	Spigot diameter	Option

Accessories

Duct system	Flexible air ducts	Grilles and hoods	Speed controllers	Clamps
BlauPlast	BlauFlex	Decor, GM	SGS E1	MCD 60/0.3 K, KZ

TRIO ONE

SILENT & ENERGY SAVING

Technical data

Model	Trio One 100
Voltage [V/Hz]	220-240/50
Power [W]	8
Current [A]	0.05
Air flow [m³/h (l/s)]	95 (26)
SFP [W/l/s]	0.3
Sound pressure level [dBA]*	27
Weight [kg]	0.45

* Sound pressure level measured in free space at a distance of 3 meters from the fan.

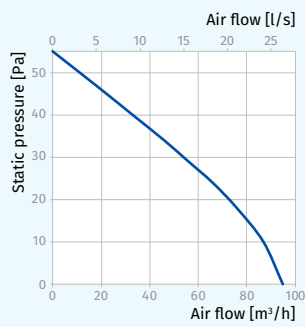

CE IP44 Zone 1

Application example

