

WIND-K

WINDOW FANS

Features



- Window mounting
- Low noise impeller
- Easy maintenance
- Ball bearing motor
- Continuous operation
- Automatic shutters
- Integrated ventilation hood with backdraft damper
- 5 year warranty



Air flow:
185 m³/h
51 l/s



Power:
22 W
SFP:
0.43 W/l/s



Noise level:
35 dBA



Options



Model	Wind-K 125				
Option	S	T	ST	H	SH
Pull-cord switch	•		•		•
Timer		•	•	•	•
Humidity sensor				•	•

- Turn-off delay time regulated between 2 and 3 min.
- Regulated humidity threshold from 60 to 90 %.

Overall dimensions and mounting

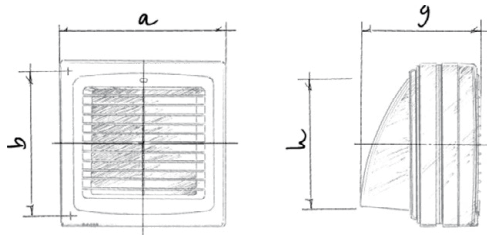

Dimensions [mm]	a	b	g	h
Wind-K 125	186	173	183	160

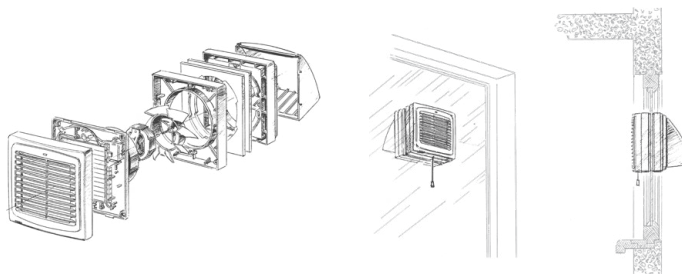

Technical data

Model	Wind-K 125
Voltage [V/Hz]	220-240/50
Power [W]	22
Current [A]	0.1
RPM [min ⁻¹]	2400
Air flow [m ³ /h (l/s)]	185 (51)
SFP [W/l/s]	0.43
Sound pressure level [dBA]*	35

* Sound pressure level measured in free space at a distance of 3 meters from the fan.

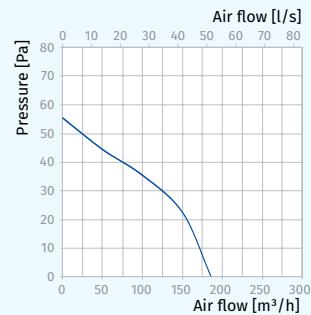

Designation key

Wind	-K	125	SH
Model	With external hood	Spigot diameter	Option



External ventilation hood

Accessories

Speed controllers



CDT E1.8



MCD 60/0.3